

IN THE SUPERIOR COURT OF THE STATE OF ARIZONA
IN AND FOR THE COUNTY OF MARICOPA

IN RE THE GENERAL
ADJUDICATION OF ALL
RIGHTS TO USE WATER IN
THE GILA RIVER SYSTEM AND
SOURCE

W-1, W-2, W-3, W-4
(Consolidated)

Contested Case No. W1-11-1432

ORDER TO INITIATE CONTESTED CASE

AND

ORDER FOR ADWR REVIEW OF ABSTRACTS
FOR *DE MINIMIS* WATER RIGHTS

AND

ORDER FOR JOINT REPORT FROM ARIZONA
STATE LAND DEPARTMENT AND LESSEE

CONTESTED CASE NAME: *In re SLD – Clifford H. Dobson, Jr. Ranch*

HSR INVOLVED: San Pedro River Watershed Hydrographic Survey Report

DESCRIPTIVE SUMMARY: Contested case W1-11-1432 initiated and twenty-six (26) abstracts prepared for ADWR review to be filed by **February 14, 2022** and joint report to be filed by the Arizona Department of Water Resources and Lessee by **April 2, 2022**.

NUMBER OF PAGES: 44

DATE OF FILING: December 14, 2021

This Order initiates a contested case to consider the claims for water rights and resolve objections to Watershed File Report 112-14-027 (“WFR”) published in the Final San Pedro River Watershed Hydrographic Survey Report (1991). The WFR identified potential water rights for stock ponds and stock watering use on land located in Sections 11, 13, 14, 16, 17, 21, 23, 25, 26,

35, and 36, in Township 15S Range 19E; and in Sections 17, 18 and 30, in Township 15S Range 20E. A copy of the WFR is attached as Attachment A. A copy of the map prepared for the WFR is attached as Attachment B. The land that is the subject of the WFR is labelled as “(27)” on the map.

Claimants & Landowner

The WFR identified Statements of Claimant numbers 39-2813, 39-2814, 39-2815, 39-2816, 39-2817, 39-2818, 39-2819, 39-2821, 39-2822, 39-2823, 39-2827, 39-2828, 39-2830, 39-7471, 39-7472, 39-7473, 39-7474, 39-7477, 39-7478, 39-7479, 30-7480, 39-11158, 39-11166, 39-11167, 39-11168, 39-13394, 39-13931, 39-13388, and 39-13389 (“SOCs”) as the relevant filings for the potential water rights filed by the Arizona State Land Department and White House Ranch. The Arizona State Land Department is named in the WFR as the owner of the property described in the WFR. The public records maintained by ASLD identify David C. Kennedy as the Lessee of the relevant land.

Adjudication of Claims

Under current law, a claimant who has asserted claims for irrigation use and Small Water Use Claims shall have the Small Water Uses Claims determined in conjunction with the claims for water for irrigation use. A.R.S. §45-257(A)(1). On December 3, 2021, *In re H. Clifford Dobson Jr. Ranch*, contested case W1-11-1481 was initiated to adjudicate claims asserted by White House Ranch for irrigation uses. This case also includes statements of claimant filed by White House Ranch for stock watering and stockpond. The term “Small Water Use Claims” includes claims for stock watering and stock ponds with a capacity of not more than 15-acre feet, A.R.S. §45-251(9).

Accordingly, it is appropriate to determine Small Water Use Claims asserted by a claimant who has also asserted claims to water rights for irrigation use in this adjudication.

Abstracts for *De Minimis* Claims

In 1994, the Special Master issued a Memorandum Decision, Findings of Fact, and Conclusions of Law for Group 1 Cases involving stock watering, stock ponds, and Domestic Uses, dated November 14, 1994, amended February 23, 1995, approved and modified September 27, 2002 (“Decision”). The Decision established the procedures for adjudicating *de minimis* water rights for claims in the San Pedro watershed. This procedure applies to the water rights for stock ponds and stock watering.

As required by the Decision, proposed water right abstracts have been prepared for the *de minimis* water rights analyzed by the WFR, which are attached as Attachment C. The abstracts will be reviewed by Arizona Department of Water Resources who will provide comments and maps designating the point of diversion and place of use. Upon receipt of a report from the Arizona Department of Water Resources, the draft abstracts will be revised as necessary and distributed to the parties for suggested corrections.

Ownership of Potential Water Rights

Permits and certificates for rights to water used on state land are governed by A.R.S §37-321.01. The statute requires that permits and certificates for the right to use water on state land for stock watering uses or stock ponds shall be issued in the name of the State of Arizona except in three circumstances.

Accordingly, if the current Lessee intends to assert rights to water for use on the land, the Lessee and the Arizona State Land Department shall meet to discuss ownership of the water rights

for stock watering and stock ponds on the land included within the boundaries of the WFR and submit a joint report regarding their respective positions as to the ownership of the potential water rights.

IT IS ORDERED:

1. Contested Case. This contested case shall be known as *In re SLD – H. Clifford Dobson, Jr. Ranch* and it will address the Statements of Claimant listed above and the objections to Watershed File Report 112-14-027 published in the Final San Pedro River Watershed Hydrographic Survey Report (1991). Copies of objections can be found under the case name and number on the following website:

<http://www.superiorcourt.maricopa.gov/SuperiorCourt/GeneralStreamAdjudication/whatsNew.asp>

2. Litigants. The litigants in this contested case are the Claimants, the current lessees, all persons who filed objections to the Watershed File Report, who are included on Attachment D, and claimants who are allowed to intervene by order.

3. Court-Approved Mailing List.

A. The initial Court-approved mailing list for this case shall include all persons listed on Attachment D to this order. The list may be modified only by filing a motion with the Special Master to amend the Court-approved mailing list. Litigants are responsible for using the current Court-approved mailing list.

B. A copy of any pleading filed with the Clerk of the Maricopa County Superior Court in this case shall be served upon each person listed on the Court-approved mailing list.

C. Claimants wishing to be added or removed from the mailing list shall file a motion with the Special Master. Parties allowed to intervene will be automatically added to the mailing list.

D. The Clerk of the Court will send copies of all minute entries and orders issued in this case to the parties listed on the Court-approved mailing list. Upon request, the Clerk of the Court will provide copies by email. Parties may request emailed copies of minute entries and orders by completing and submitting a CONSENT FOR ELECTRONIC RECEIPT OF WATER CASE DOCUMENTS, which is attached as Attachment E.

4. By **February 14, 2022**, ADWR shall review and file a report with its comments on the draft abstracts attached as Attachment C and prepare maps regarding the potential water rights.

5. By **April 2, 2022**, the Lessee who intends to assert water rights and Arizona State Land Department shall file a joint report regarding ownership of the proposed water rights identified in the draft abstracts attached as Attachment C.

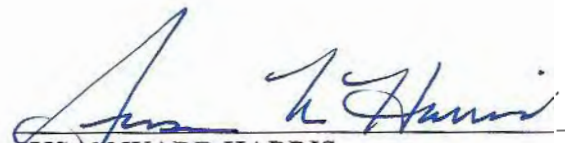
SUSAN WARD HARRIS
Special Master

On December 14, 2021 the original of the foregoing was delivered to the Clerk of the Maricopa County Superior Court for filing and distributing a copy to all persons listed on the Court-approved mailing list for this contested case, a copy of which is attached hereto as Attachment D, and to all persons listed on the Court-approved mailing list for W-1, W-2, W-3, and W-4 (Consolidated).

Emily Natale

ATTACHMENT A

LAND OWNER

WATERSHED FILE
REPORT NUMBER

LESSEE/ALLOTTEE

LEASE-PERMIT ID

SLD

112-14-027

DOBSON, JR., H. CLIFFORD
RANCH

05-1279

A P P L I C A B L E F I L I N G S A N D D E C R E E S

CLEARLY STATED INFORMATION FROM FILINGS AND DECREES

WI-11-1432

FILING NUMBER	FILING STATUS	USES	QUANTITY IN AFA	USE LOCATION SECTION	TWNP	RNGE	CLAIM DATE	DIVERSION SECTION	LDCATION TWNP	RNGE
3R-0001576	CERTIF.	STOCK	.18	SWNW21	150N	190E	1957	SWNW21	150S	190E
3R-0001578	CERTIF.	STOCK	.31	SWSE36	150S	190E	1957	SWSE36	150S	190E
3R-0001579	CERTIF.	STOCK	.40	SESW17	150S	200E	1957	SESW17	150S	200E
33-0078266	APPLICA.	STOCK	.56	SWNW21	150S	190E	1979	SWNW21	150S	190E
		REC/FISH/WLDF	.15							
36-0005275		STOCK	.34	SWSE13	150S	190E	1884	SWSE13	150S	190E
		REC/FISH/WLDF								
36-0005276		STOCK	.36	SESW14	150S	190E	1884	SESW14	150S	190E
		REC/FISH/WLDF								
36-0005277		STOCK	.60	SWNW21	150S	190E	1884	SWNW21	150S	190E
		REC/FISH/WLDF								
36-0005278		STOCK	1.00	SWSE36	150S	190E	1884	SWSE36	150S	190E
		REC/FISH/WLDF								
36-0005280		STOCK	1.20	SESW17	150S	200E	1884	SESW17	150S	200E
		REC/FISH/WLDF								
36-0005281		STOCK	8.40	SESW17	150S	200E	1884	SESW17	150S	200E
		REC/FISH/WLDF								
36-0005282		STOCK	4.60	SESE18	150S	200E	1884	SESE18	150S	200E
		REC/FISH/WLDF								
36-0005283		STOCK	.50	SWSW30	150S	200E	1884	SWSW30	150S	200E
		REC/FISH/WLDF								
36-0005613		STOCK	.76	NESW16	150S	190E	1884	NESW16	150S	190E
		REC/FISH/WLDF								
36-0005614		STOCK	.60	SESW21	150S	190E	1884	SESW21	150S	190E
		REC/FISH/WLDF								
36-0005618		STOCK	2.10	SESE18	150S	200E	1884	SESE18	150S	200E
		REC/FISH/WLDF								
36-0100074		STOCK	1.53	NWNE23	150S	190E	1884	NWNE23	150S	190E
		REC/FISH/WLDF	.17							
36-0100076		STOCK	1.00	SESW26	150S	190E	1884	SESW26	150S	190E
		REC/FISH/WLDF	.11							
36-0100077		STOCK	2.18	SWNW35	150S	190E	1884	SWNW35	150S	190E
		REC/FISH/WLDF	.24							
38-0013537		STOCK	.03	NWSE13	150S	190E	1950	NWSE13	150S	190E
		REC/FISH/WLDF								
38-0013537.0001		STOCK	.02	NWSE13	150S	190E	1950	NWSE13	150S	190E
		REC/FISH/WLDF								
38-0015356		STOCK	.33	SESW14	150S	190E	1950	SESW14	150S	190E
		REC/FISH/WLDF								
38-0015358.0001		STOCK	2.00	SESE18	150S	200E	1950	SESE18	150S	200E
		REC/FISH/WLDF								
38-0015359		STOCK	1.00	SESW21	150S	190E	1950	SESW21	150S	190E
		REC/FISH/WLDF								
38-0015360		STOCK	1.15	NWNE23	150S	190E	1950	NWNE23	150S	190E
		REC/FISH/WLDF								
38-0015361		STOCK	.25	SWNE26	150S	190E	1950	SWNE26	150S	190E
		REC/FISH/WLDF								
38-0015362		STOCK	1.18	SWNW35	150S	190E	1950	SWNW35	150S	190E
		REC/FISH/WLDF								
38-0015363		STOCK	2.10	SWSE36	150S	190E	1950	SWSE36	150S	190E
		REC/FISH/WLDF								
38-0015364		STOCK	.10	SWSW30	150S	200E	1950	SWSW30	150S	200E
		REC/FISH/WLDF								
38-0015365.0001		STOCK	1.05	SESW17	150S	200E	1950	SESW17	150S	200E
		REC/FISH/WLDF								
38-0015366		STOCK	6.00	SESW17	150S	200E	1950	SESW17	150S	200E
		REC/FISH/WLDF								
38-0023188.0001		STOCK	1.00	NWNWNE23	150S	190E	1950	NWNWNE23	150S	190E
		REC/FISH/WLDF								
38-0088389		STOCK	1.20	SWSW30	150S	200E	1950	SWSW30	150S	200E
		REC/FISH/WLDF								
38-0088627		STOCK	1.00	SWSE36	150S	190E	1950	SWSE36	150S	190E
		REC/FISH/WLDF								
38-0088637		STOCK	8.40	SESW17	150S	200E	1950	SESW17	150S	200E
		REC/FISH/WLDF								

CLEARLY STATED INFORMATION FROM FILINGS AND DECREES

FILING NUMBER	FILING STATUS	USES	QUANTITY IN AFA	USE SECTION	TWNP	RNGE	CLAIM DATE	DIVERSION SECTION	TWNP	LOCATION RNGE
38-0088650		STOCK	1.20	SESW17	150S	200E		SESW17	150S	200E
38-0088682		REC/FISH/WLDLF	.14	NESW14	150S	190E	1950	NESW14	150S	190E
38-0088683		STOCK	.34	NWSE13	150S	190E	1973	NWSE13	150S	190E
38-0088713		REC/FISH/WLDLF	.11	SWNW21	150S	190E	1973	SWNW21	150S	190E
38-0088750		STOCK	4.60	SESE18	150S	200E	1950	SESE18	150S	200E
38-0088796.0001		REC/FISH/WLDLF	.14	SESW17	150S	200E		SESW17	150S	200E
38-0088814		STOCK	.14	SESW17	150S	200E		SESW17	150S	200E
38-0088815		REC/FISH/WLDLF	.28	SESW17	150S	200E		SESW17	150S	200E
38-0094537		STOCK	3.00	SESE18	150S	200E	1950	SESE18	150S	200E
38-0094633		REC/FISH/WLDLF	.60	SESE18	150S	200E		SESE18	150S	200E
38-0094753		STOCK		SESW17	150S	200E		SESW17	150S	200E
39-0002807		REC/FISH/WLDLF	2.24	SESW17	150S	200E	1950	SESW17	150S	200E
39-0002813		STOCK	.31	SESW17	150S	200E		SESW17	150S	200E
39-0002814		REC/FISH/WLDLF	.77	NESW16	150S	190E	1950	NESW16	150S	190E
39-0002815		STOCK	.08	NWSE13	150S	190E	1950	NWSE13	150S	190E
39-0002816		REC/FISH/WLDLF	.02	NWSE13	150S	190E		NWSE13	150S	190E
39-0002817		STOCK	.01	NWSE13	150S	190E		NWSE13	150S	190E
39-0002818		REC/FISH/WLDLF	1.06	SWNW35	150S	190E	1950	SWNW35	150S	190E
39-0002819		STOCK	.12	SWNW35	150S	190E		SWNW35	150S	190E
39-0002821		REC/FISH/WLDLF	1.90	SWSE36	150S	190E	1950	SWSE36	150S	190E
39-0002822		STOCK	.20	SWSE36	150S	190E		SWSE36	150S	190E
39-0002823		REC/FISH/WLDLF	.09	SWSW30	150S	200E	1950	SWSW30	150S	200E
39-0002824		STOCK	102.00	SWSW30	150S	200E		SWSW30	150S	200E
39-0002825		REC/FISH/WLDLF	5.40	SESW17	150S	200E	1950	SESW17	150S	200E
39-0002826		STOCK	.60	SESW17	150S	200E		SESW17	150S	200E
39-0002827		REC/FISH/WLDLF	.98	SESW17	150S	200E	1950	SESW17	150S	200E
39-0002828		STOCK	.11	SESW17	150S	200E		SESW17	150S	200E
39-0002829		REC/FISH/WLDLF	.09	SESW17	150S	200E		SESW17	150S	200E
39-0002830		STOCK	.01	SESW17	150S	200E		SESW17	150S	200E
39-0002831		REC/FISH/WLDLF	1.80	SESE18	150S	200E	1950	SESE18	150S	200E
39-0002832		STOCK	.20	SESE18	150S	200E		SESE18	150S	200E
39-0002833		REC/FISH/WLDLF	1.04	NWNE23	150S	190E	1950	NWNE23	150S	190E
39-0002834		STOCK	.11	NWNE23	150S	190E		NWNE23	150S	190E
39-0002835		REC/FISH/WLDLF	.22	SWSW26	150S	190E	1950	SWSW26	150S	190E
39-0002836		STOCK	.08	SWSW26	150S	190E		SWSW26	150S	190E
39-0002837		REC/FISH/WLDLF	.23	SWNE26	150S	190E	1950	SWNE26	150S	190E
39-0002838		STOCK	.02	SWNE26	150S	190E		SWNE26	150S	190E
39-0002839		REC/FISH/WLDLF	.56	SWNW21	150S	190E	1940	SWNW21	150S	190E
39-0002840		STOCK	.15	SWNW21	150S	190E		SWNW21	150S	190E
39-0002841		REC/FISH/WLDLF	.30	SESW17	150S	200E	1950	SESW17	150S	200E
39-0002842		STOCK	.03	SESW17	150S	200E		SESW17	150S	200E
39-0002843		REC/FISH/WLDLF	2.24	SESW17	150S	200E	1960	SESW17	150S	200E
39-0002844		STOCK	.31	SESW17	150S	200E		SESW17	150S	200E
39-0002845		REC/FISH/WLDLF	3.07	SWSWSW30	150S	200E	1954	SWSWSW30	150S	200E
39-0002846		STOCK	.31	SWSWSW30	150S	200E		SWSWSW30	150S	200E
39-0007471	AMENDED	REC/FISH/WLDLF	.32	NWSE13	150S	190E	1884	NWSE13	150S	190E
39-0007472	AMENDED	STOCK	.04	NWSE13	150S	190E		NWSE13	150S	190E
39-0007473	AMENDED	REC/FISH/WLDLF	.32	SESW17	150S	200E	1884	SESW17	150S	200E
39-0007474	AMENDED	STOCK	.04	SESW17	150S	200E		SESW17	150S	200E
39-0007475	AMENDED	REC/FISH/WLDLF	.50	SWNW21	150S	190E	1884	SWNW21	150S	190E
39-0007476	AMENDED	STOCK	.10	SWNW21	150S	190E		SWNW21	150S	190E
39-0007477	AMENDED	REC/FISH/WLDLF	.90	SWSE36	150S	190E	1853	SWSE36	150S	190E
39-0007478	AMENDED	STOCK	.10	SWSE36	150S	190E		SWSE36	150S	190E
39-0007479	AMENDED	REC/FISH/WLDLF	1.00	SESW17	150S	200E	1884	SESW17	150S	200E
39-0007480	AMENDED	STOCK	.20	SESW17	150S	200E		SESW17	150S	200E
39-0007481	AMENDED	REC/FISH/WLDLF	7.60	SESW17	150S	200E	1884	SESW17	150S	200E
39-0007482	AMENDED	STOCK	.80	SESW17	150S	200E		SESW17	150S	200E
39-0007483	AMENDED	REC/FISH/WLDLF	4.10	SESE18	150S	200E	1884	SESE18	150S	200E
39-0007484	AMENDED	STOCK	.50	SESE18	150S	200E		SESE18	150S	200E
39-0007485	AMENDED	REC/FISH/WLDLF	.45	SWSW30	150S	200E	1884	SWSW30	150S	200E
39-0007486	AMENDED	STOCK	.05	SWSW30	150S	200E		SWSW30	150S	200E

CLEARLY STATED INFORMATION FROM FILINGS AND DECREES

FILING NUMBER	FILING STATUS	USES	QUANTITY IN AFA	USE LOCATION SECTION	TWNP	RNGE	CLAIM DATE	DIVERSION LOCATION SECTION	TWNP	RNGE
39-0011158		STOCK	1.45	NWNE23	150S	190E		NWNE23	150S	190E
		REC/FISH/WLDF	.25							
39-0011166	AMENDED	STOCK	2.70	SWNW35	150S	190E	1884	SWNW35	150S	190E
		REC/FISH/WLDF	.30							
39-0011167	AMENDED	STDCK	1.80	NWNE23	150S	190E	1884	NWNE23	150S	190E
		REC/FISH/WLDF	.20							
39-0011168	AMENDED	STOCK	1.00	SENW26	150S	190E	1884	SENW26	150S	190E
		REC/FISH/WLDF	.11							
39-0013388		STOCK	.70	NESW16	150S	190E	1853	NESW16	150S	190E
		REC/FISH/WLDF	.06							
39-0013389		STOCK	.54	SENW21	150S	190E	1884	SENW21	150S	190E
		REC/FISH/WLDF	.06							
39-0013394		STOCK	1.89	SESE18	150S	200E	1884	SESE18	150S	200E
		REC/FISH/WLDF	.21							
39-0013395		STOCK	.32	SWSWSW30	150S	200E	1920	SWSWSW30	150S	200E
		REC/FISH/WLDF	.04							
39-0013931		STOCK	.88	SESWSW26	150S	190E	1960	SESWSW26	150S	190E
		REC/FISH/WLDF								
4A-0000517	CERTIF.	STOCK	72.39	SWNW33	150S	190E	1924	SWNW33	150S	190E

DWR ANALYSIS OF FILINGS AND DECREES

FILING NUMBER	USES CLAIMED OR REFERENCED	USES FOUND BY DWR	APPLIES TO DIVERSIONS	APPLIES TO PWR NUMBERS
3R-0001576	STOCK	STOCK		SPO04
3R-0001578	STOCK	STOCK		SPO06
3R-0001579	STOCK	STOCK		SPO08
33-0078266	STOCK	STOCK		SPO04
	WILDLIFE	INCIDENTAL		
36-0005275	STDCK	STOCK		SW002
	WILDLIFE	INCIDENTAL		
36-0005276	STOCK	STOCK		SW003
	WILDLIFE	INCIDENTAL		
36-0005277	STOCK	STOCK		SW005
	WILDLIFE	INCIDENTAL		
36-0005278	STOCK	STOCK		SW006
	WILDLIFE	INCIDENTAL		
36-0005280	STOCK	STOCK		SW007
	WILDLIFE	INCIDENTAL		
36-0005281	STOCK	STOCK		SW007
	WILDLIFE	INCIDENTAL		
36-0005282	STOCK	STOCK		SW008
	WILDLIFE	INCIDENTAL		
36-0005283	STOCK	STOCK		SW012
	WILDLIFE	INCIDENTAL		
36-0005613	STOCK	STOCK		SW004
	WILDLIFE	INCIDENTAL		
36-0005614	STOCK	STOCK		SW013
	WILDLIFE	INCIDENTAL		
36-0005618	STOCK	STOCK		SW014
	WILDLIFE	INCIDENTAL		
36-0100074	STOCK	STOCK		SW009
	WILDLIFE	INCIDENTAL		
36-0100076	STOCK	STOCK		SW010
	WILDLIFE	INCIDENTAL		
36-0100077	STDCK	STDCK		SW011
	WILDLIFE	INCIDENTAL		
38-0013537	STOCK	STOCK		SPO01
	WILDLIFE	INCIDENTAL		
38-0013537.0001	STOCK	STOCK		SPO01
	WILDLIFE	INCIDENTAL		
38-0015356	STDCK	STOCK		SPO02
	WILDLIFE	INCIDENTAL		
38-0015358.0001	STDCK	STOCK		SPO09
	WILDLIFE	INCIDENTAL		
38-0015359	STOCK	STOCK		SPO15
	WILDLIFE	INCIDENTAL		
38-0015360	STOCK	STOCK		SPO11
	WILDLIFE	INCIDENTAL		
38-0015361	STOCK	STOCK		SPO12

FILING NUMBER	USES CLAIMED DR REFERENCED	USES FOUND BY DWR	APPLIES TO DIVERSIONS	APPLIES TO PWR NUMBERS
38-0015361	WILDLIFE	INCIDENTAL		
38-0015362	STOCK	STOCK		SP013
38-0015363	WILDLIFE	INCIDENTAL		
	STOCK	STOCK		SP006
38-0015364	WILDLIFE	INCIDENTAL		
	STOCK	STOCK		SP014
38-0015365.0001	WILDLIFE	INCIDENTAL		
	STOCK	STOCK		SP007
38-0015366	WILDLIFE	INCIDENTAL		
	STOCK	STOCK		SP008
38-0023188.0001	WILDLIFE	INCIDENTAL		
	STOCK	STOCK		SP011
38-0088389	WILDLIFE	INCIDENTAL		
	STOCK	STOCK		SP014
38-0088627	WILDLIFE	INCIDENTAL		
	STOCK	STOCK		SP006
38-0088637	WILDLIFE	INCIDENTAL		
	STOCK	STOCK		SP008
38-0088650	WILDLIFE	INCIDENTAL		
	STOCK	STOCK		SP007
38-0088682	WILDLIFE	INCIDENTAL		
	STOCK	STOCK		SP002
38-0088683	WILDLIFE	INCIDENTAL		
	STOCK	STOCK		SP001
38-0088713	WILDLIFE	INCIDENTAL		
	STOCK	STOCK		SP004
38-0088750	WILDLIFE	INCIDENTAL		
	STOCK	STOCK		SP009
38-0088796.0001	WILDLIFE	INCIDENTAL		
	STOCK	STOCK		SP012
38-0088814	WILDLIFE	INCIDENTAL		
	STOCK	STOCK		SP003
38-0088815	WILDLIFE	INCIDENTAL		
	STOCK	STOCK		SP012
38-0094537	WILDLIFE	INCIDENTAL		
	STOCK	STOCK		SP010
38-0094633	WILDLIFE	INCIDENTAL		
	STOCK	STOCK		SP015
38-0094753	WILDLIFE	INCIDENTAL		
	STOCK	STOCK		SP013
39-0002807	WILDLIFE	INCIDENTAL		
	STOCK	CATALOGUED WELL		
39-0002813	WILDLIFE	CATALOGUED WELL		
	STOCK	STOCK		SP003
39-0002814	WILDLIFE	INCIDENTAL		
	STOCK	STOCK		SP001
39-0002815	WILDLIFE	INCIDENTAL		
	STOCK	STOCK		SP013
39-0002816	WILDLIFE	INCIDENTAL		
	STOCK	STOCK		SP006
39-0002817	WILDLIFE	INCIDENTAL		
	STOCK	STOCK		SP014
39-0002818	WILDLIFE	INCIDENTAL		
	STOCK	STOCK		SP008
39-0002819	WILDLIFE	INCIDENTAL		
	STOCK	STOCK		SP007
39-0002821	WILDLIFE	INCIDENTAL		
	STOCK	STOCK		SP015
39-0002822	WILDLIFE	INCIDENTAL		
	STOCK	STOCK		SP009
39-0002823	WILDLIFE	INCIDENTAL		
	STOCK	STOCK		SP011
39-0002825	WILDLIFE	INCIDENTAL		
	STOCK	SPRING		
39-0002827	WILDLIFE	INCIDENTAL		
	STOCK	SPRING		
39-0002828	WILDLIFE	INCIDENTAL		
	STOCK	STOCK		SP012
39-0002830	WILDLIFE	INCIDENTAL		
	STOCK	STOCK		SP004
39-0002835	WILDLIFE	INCIDENTAL		
	STOCK	CATALOGUED WELL		
39-0002836	WILDLIFE	CATALOGUED WELL		
	STOCK	CATALOGUED WELL		

FILING NUMBER	USES CLAIMED OR REFERENCED	USES FOUND BY DWR	APPLIES TO DIVERSIONS	APPLIES TO PWR NUMBERS
39-0002836	WILDLIFE	CATALOGUED WELL		
39-0007471	STOCK	STOCK		SPO01, SW002
39-0007472	WILDLIFE	INCIDENTAL		
39-0007473	STOCK	STOCK		SPO02, SW003
39-0007473	WILDLIFE	INCIDENTAL		
39-0007473	STOCK	STOCK		SPO04, SW005
39-0007474	WILDLIFE	INCIDENTAL		
39-0007474	STOCK	STOCK		SPO06, SW006
39-0007477	WILDLIFE	INCIDENTAL		
39-0007477	STOCK	STOCK		SPO07, SW007
39-0007478	WILDLIFE	INCIDENTAL		
39-0007478	STOCK	STOCK		SPO08, SW007
39-0007479	WILDLIFE	INCIDENTAL		
39-0007479	STOCK	STOCK		SPO09, SW008
39-0007480	WILDLIFE	INCIDENTAL		
39-0007480	STOCK	STOCK		SPO14, SW012
39-0011158	WILDLIFE	INCIDENTAL		
39-0011158	STOCK	STOCK		SPO11
39-0011166	WILDLIFE	INCIDENTAL		
39-0011166	STOCK	STOCK		SPO13, SW011
39-0011167	WILDLIFE	INCIDENTAL		
39-0011167	STOCK	STOCK		SPO11, SW009
39-0011168	WILDLIFE	INCIDENTAL		
39-0011168	STOCK	STOCK		SPO12, SW010
39-0013388	WILDLIFE	INCIDENTAL		
39-0013388	STOCK	STOCK		SPO03, SW004
39-0013389	WILDLIFE	INCIDENTAL		
39-0013389	STOCK	STOCK		SPO15, SW013
39-0013394	WILDLIFE	INCIDENTAL		
39-0013394	STOCK	STOCK		SPO10, SW014
39-0013395	WILDLIFE	INCIDENTAL		
39-0013395	STOCK	CATALOGUED WELL		
39-0013931	WILDLIFE	CATALOGUED WELL		
39-0013931	STOCK	CATALOGUED WELL		
4A-0000517	WILDLIFE	CATALOGUED WELL		
4A-0000517	STOCK	SPRING		

U S E S

PWR #	LOCATION SECTION TWNP RNGE	SUPPLIED BY DIVERSIONS	WATER SOURCES	PHOTO DATE	SOURCE CHANGE	FACILITY NAME
SW002	NENESW13 150S 190E		SURFACE WATER		NO	INSTREAM USE
SW003	SESESW11 150S 190E		SURFACE WATER		NO	INSTREAM USE
SW004	SWSWNW16 150S 190E		SURFACE WATER		NO	INSTREAM USE
SW005	NESWSE17 150S 190E		SURFACE WATER		NO	INSTREAM USE
SW006	NWNWSE36 150S 190E		SURFACE WATER		NO	INSTREAM USE
SW007	SESESW17 150S 200E		SURFACE WATER		NO	INSTREAM USE
SW008	NESWSE18 150S 200E		SURFACE WATER		NO	INSTREAM USE
SW009	NWSWSE14 150S 190E		SURFACE WATER		NO	INSTREAM USE
SW010	NWNESW23 150S 190E		SURFACE WATER		NO	INSTREAM USE
SW011	NWNWNW35 150S 190E		SURFACE WATER		NO	INSTREAM USE
SW012	NESWNE25 150S 190E		SURFACE WATER		NO	INSTREAM USE
SW013	SESENW21 150S 190E		SURFACE WATER		NO	INSTREAM USE
SW014	SWSESE18 150S 200E		SURFACE WATER		NO	INSTREAM USE

R E S E R V O I R S

PWR #	LOCATION SECTION TWNP RNGE	SUPPLIED BY DIVERSIONS	WATER SOURCES	PHOTO DATE	RESERVDIR NAME	STORAGE PURPOSE
SPO01	NESESE13 150S 190E		SURFACE WATER	1955	LOWER 13 TANK	STOCKWATERING WILDLIFE
SPO02	SESENW14 150S 190E		SURFACE WATER	1979	HOMESTEAD TANK	STOCKWATERING WILDLIFE
SPO03	NWNESW16 150S 190E		SURFACE WATER	1979	SECTION 16 TANK	STOCKWATERING WILDLIFE
SPO04	SWSWNW21 150S 190E		SURFACE WATER	1979	CANOA SPRING TANK	STOCKWATERING WILDLIFE
SPO05	SWNESE36 150S 190E		SURFACE WATER	1955	UNNAMED	STOCKWATERING
SPO06	NESWSE36 150S 190E		SURFACE WATER	1955	NUMBER 3 TANK	STOCKWATERING WILDLIFE

PWR #	LOCATION			SUPPLIED BY		PHOTO DATE	RESERVOIR NAME	STORAGE PURPOSE
	SECTION	TWNP	RNGE	DIVERSIONS	WATER SOURCES			
SPO07	NESESW17	150S	200E		SURFACE WATER	1955	NORTH TWIN TANK	STOCKWATERING WILDLIFE
SPO08	NESESW17	150S	200E		SURFACE WATER	1955	SOUTH TWIN TANK	STOCKWATERING WILDLIFE
SPO09	SESESE18	150S	200E		SURFACE WATER	1972	SECTION 18 TANK	STOCKWATERING WILDLIFE
SPO10	SESESE18	150S	200E		SURFACE WATER	1972	LOWER SECT. 18 TANK	STOCKWATERING WILDLIFE
SPO11	NWNWNE23	150S	190E		SURFACE WATER	1979	SECTION 23 TANK	STOCKWATERING WILDLIFE
SPO12	NESESW26	150S	190E		SURFACE WATER	1955	SECTION 26 TANK	STOCKWATERING WILDLIFE
SPO13	NWSWNW35	150S	190E		SURFACE WATER	1955	SECTION 35 TANK	STOCKWATERING WILDLIFE
SPO14	SWSWSW30	150S	200E		SURFACE WATER	1955	RDAD MILL TANK	STOCKWATERING WILDLIFE
SPO15	SESESW21	150S	190E		SURFACE WATER	1979	SECTION 21 TANK	STOCKWATERING WILDLIFE

PWR SUMMARY

PWR #	APPLICABLE	APPLICABLE	*APPARENT FIRST USE DATE*		WATER SOURCES AND CLASSIFICATIONS
	ADJ FILINGS	PRE FILINGS	DATE BASIS	FOR DATE	
SPO01	39-0002814 39-0007471	38-0013537 38-0013537.0001 38-0088683	1950	FILING 38-13537.0001	SURFACE WATER: SAN PEDRO RIVER
SPO02	39-0002830 39-0007472	38-0015356 38-0088682	1950	38-15356 & 33-88682	SURFACE WATER: SAN PEDRO RIVER
SPO03	39-0002813 39-0013388	38-0088814	1977	FILING 38-88814	SURFACE WATER: SAN PEDRO RIVER
SPO04	39-0002828 39-0007473	3R-0001576 33-0078266 38-0088713	1957	FILING 3R-1576	SURFACE WATER: SAN PEDRO RIVER
SPO05	NONE	NONE	1955	1955 AERIAL PHOTO	SURFACE WATER: SAN PEDRO RIVER
SPO06	39-0002816 39-0007474	3R-0001578 38-0015363 38-0088627	1950	38-15363 & 38-88627	SURFACE WATER: SAN PEDRO RIVER
SPO07	39-0002819 39-0007477	38-0015365.0001 38-0088650	1950	38-15365 & 38-88650	SURFACE WATER: SAN PEDRO RIVER
SPO08	39-0002818 39-0007478	3R-0001579 38-0015366 38-0088637	1950	38-15366 & 38-88637	SURFACE WATER: SAN PEDRO RIVER
SPO09	39-0002822 39-0007479	38-0015358.0001 38-0088750	1950	38-15358 & 38-88750	SURFACE WATER: SAN PEDRO RIVER
SPO10	39-0013394	38-0094537	1972	1972 AERIAL PHOTO	SURFACE WATER: SAN PEDRO RIVER
SPO11	39-0002823 39-0011158 39-0011167	38-0015360 38-0023188.0001	1950	38-15360 & 38-23188	SURFACE WATER: SAN PEDRO RIVER
SPO12	39-0002827 39-0011168	38-0015361 38-0088796.0001 38-0088815	1950	38-15361 & 38-88815	SURFACE WATER: SAN PEDRO RIVER
SPO13	39-0002815 39-0011166	38-0015362 38-0094753	1950	38-15362 & 38-94753	SURFACE WATER: SAN PEDRO RIVER
SPO14	39-0002817 39-0007480	38-0015364 38-0088389	1950	38-15364 & 38-88389	SURFACE WATER: SAN PEDRO RIVER
SPO15	39-0002821 39-0013389	38-0015359 38-0094633	1950	38-15359 & 38-94633	SURFACE WATER: SAN PEDRO RIVER
SW002	39-0007471	36-0005275	1884	FILING 36-5275	SURFACE WATER: SAN PEDRO RIVER
SW003	39-0007472	36-0005276	1884	FILING 36-5276	SURFACE WATER: SAN PEDRO RIVER
SW004	39-0013388	36-0005613	1884	FILING 36-5613	SURFACE WATER: SAN PEDRO RIVER
SW005	39-0007473	36-0005277	1884	FILING 36-5277	SURFACE WATER: SAN PEDRO RIVER
SW006	39-0007474	36-0005278	1884	FILING 36-5278	SURFACE WATER: SAN PEDRO RIVER
SW007	39-0007477 39-0007478	36-0005280 36-0005281	1884	36-5280 & 36-5281	SURFACE WATER: SAN PEDRO RIVER
SW008	39-0007479	36-0005282	1884	FILING 36-5282	SURFACE WATER: SAN PEDRO RIVER
SW009	39-0011167	36-0100074	1884	FILING 36-100074	SURFACE WATER: SAN PEDRO RIVER
SW010	39-0011168	36-0100076	1884	FILING 36-100076	SURFACE WATER: SAN PEDRO RIVER
SW011	39-0011166	36-0100077	1884	FILING 36-100077	SURFACE WATER: SAN PEDRO RIVER
SW012	39-0007480	36-0005283	1884	FILING 36-5283	SURFACE WATER: SAN PEDRO RIVER
SW013	39-0013389	36-0005614	1884	FILING 36-5614	SURFACE WATER: SAN PEDRO RIVER
SW014	39-0013394	36-0005618	1884	FILING 36-5618	SURFACE WATER: SAN PEDRO RIVER
NONE	39-0002807	4A-0000517			

PWR #	APPLICABLE ADJ FILINGS	APPLICABLE PRE FILINGS	*APPARENT FIRST USE DATE* DATE BASIS FOR DATE	WATER SOURCES AND CLASSIFICATIONS
NONE	39-0002825			
	39-0002835			
	39-0002836			
	39-0013395			
	39-0013931			

QUANTITIES OF USE

PWR #	QUANTIFICATION TYPE	ACRES	CROP TYPE	EFF	WATER DUTY	ESTIMATED VOLUME	REMARKS
SPO01	MAX. AREA/CAP	LT 2.0				LTE 15.0 AF	
SPO02	MAX. AREA/CAP	LT 2.0				LTE 15.0 AF	
SPO03	MAX. AREA/CAP	.1				.2 AF	
SPO04	MAX. AREA/CAP	LT 2.0				LTE 15.0 AF	
SPO05	MAX. AREA/CAP	LT 2.0				LTE 15.0 AF	
SPO06	MAX. AREA/CAP	LT 2.0				LTE 15.0 AF	
SPO07	MAX. AREA/CAP	LT 2.0				LTE 15.0 AF	
SPO08	MAX. AREA/CAP	1.0				8.4 AF	
SPO09	MAX. AREA/CAP	.8				4.6 AF	
SPO10	MAX. AREA/CAP	LT 2.0				LTE 15.0 AF	
SPO11	MAX. AREA/CAP	.4				2.0 AF	
SPO12	MAX. AREA/CAP	LT 2.0				LTE 15.0 AF	
SPO13	MAX. AREA/CAP	2.0				2.9 AF	
SPO14	MAX. AREA/CAP	LT 2.0				LTE 15.0 AF	
SPO15	MAX. AREA/CAP	LT 2.0				LTE 15.0 AF	
SW002							SEE VOLUME 1 - GENERAL ASSESSMENT
SW003							SEE VOLUME 1 - GENERAL ASSESSMENT
SW004							SEE VOLUME 1 - GENERAL ASSESSMENT
SW005							SEE VOLUME 1 - GENERAL ASSESSMENT
SW006							SEE VOLUME 1 - GENERAL ASSESSMENT
SW007							SEE VOLUME 1 - GENERAL ASSESSMENT
SW008							SEE VOLUME 1 - GENERAL ASSESSMENT
SW009							SEE VOLUME 1 - GENERAL ASSESSMENT
SW010							SEE VOLUME 1 - GENERAL ASSESSMENT
SW011							SEE VOLUME 1 - GENERAL ASSESSMENT
SW012							SEE VOLUME 1 - GENERAL ASSESSMENT
SW013							SEE VOLUME 1 - GENERAL ASSESSMENT
SW014							SEE VOLUME 1 - GENERAL ASSESSMENT

EXPLANATION

FILINGS AND DECREES

FILING 39-2825 - CLAIMS STOCKWATERING AND WILDLIFE USES FROM SECTION 26 SPRING.
FILING 39-7474 - CLAIMS A FEDERAL RESERVED WATER RIGHT PRIORITY DATE OF 1853, BUT THE CLAIMED DATE OF FIRST BENEFICIAL WATER USE IS 1883.
FILING 39-11158 - SLD HAS REQUESTED THE WITHDRAWAL OF THIS FILING. A STATEMENT OF CLAIMANT CAN ONLY BE WITHDRAWN BY A COURT ORDER.
FILING 39-13388 - CLAIMS A FEDERAL RESERVED WATER RIGHT PRIORITY DATE OF 1853, BUT THE CLAIMED DATE OF FIRST BENEFICIAL WATER USE IS PRIOR TO 1884.
FILING 39-13395 - CLAIMS A FEDERAL RESERVED WATER RIGHT PRIORITY DATE OF 1920, BUT THE CLAIMED DATE OF FIRST BENEFICIAL WATER USE IS 1954.

USES AND RESERVOIRS

SP1 - LOWER 13 TANK STOCKPOND, AKA NUMBER 2 TANK.
SP2 - HOMESTEAD TANK STOCKPOND, AKA SECTION 14 TANK.
SP3 - SECTION 16 TANK STOCKPOND.
SP4 - CANOA SPRING TANK STOCKPOND.

SP5 - UNNAMED STOCKPOND.
SP6 - NUMBER 3 TANK STOCKPOND, AKA SECTION 36 TANK.
SP7 - NORTH TWIN TANK STOCKPOND, AKA UPPER TWIN TANK.
SP8 - SOUTH TWIN TANK STOCKPOND.
SP9 - SECTION 18 TANK STOCKPOND, AKA NUMBER 1 TANK.
SP10 - LOWER SECTION 18 STOCKPOND.
SP11 - SECTION 23 TANK STOCKPOND.
SP12 - SECTION 26 TANK STOCKPOND.
SP13 - SECTION 35 TANK STOCKPOND.
SP14 - ROAD MILL TANK STOCKPOND.
SP15 - SECTION 21 TANK STOCKPOND.
SW2 - INSTREAM STOCKWATERING AND WILDLIFE USES FROM LOWER WASH.
SW3 - INSTREAM STOCKWATERING AND WILDLIFE USES FROM HOMESTEAD WASH.
SW4 - INSTREAM STOCKWATERING AND WILDILFE USES FROM TRAIL WASH I.
SW5 - INSTREAM STOCKWATERING AND WILDLIFE USES FROM CANOA WASH.
SW6 - INSTREAM STOCKWATERING AND WILDLIFE USES FROM WILLOW WASH.
SW7 - INSTREAM STOCKWATERING AND WILDLIFE USES FROM UPPER WASH.
SW8 - INSTREAM STOCKWATERING AND WILDLIFE USES FROM SMALL WASH.
SW9 - INSTREAM STOCKWATERING AND WILDLIFE USES FROM TANK DRAW.
SW10 - INSTREAM STOCKWATERING AND WILDLIFE USES FROM ROAD WASH.
SW11 - INSTREAM STOCKWATERING AND WILDLIFE USES FROM 35 DRAW.
SW12 - INSTREAM STOCKWATERING AND WILDLIFE USES FROM MILL WASH.
SW13 - INSTREAM STOCKWATERING AND WILDLIFE USES FROM TRAIL WASH II.
SW14 - INSTREAM STOCKWATERING AND WILDLIFE USES FROM NUMBER 18 DRAW.

QUANTITIES OF USE

SP4 - FILING 3R-1576 STATES A CERTIFICATED STOCKPOND CAPACITY OF 0.25 ACRE-FEET.
SP6 - FILING 3R-1578 STATES A CERTIFICATED STOCKPOND CAPACITY OF 0.54 ACRE-FEET.
SP8 - FILING 3R-1579 STATES A CERTIFICATED STOCKPOND CAPACITY OF 1.33 ACRE-FEET.

DISPOSITION OF LAND OWNER/CLAIMANT COMMENTS

A COMMENT FROM THE 1987 PRELIMINARY H.S.R. WAS RECEIVED FROM THE LAND OWNER WHICH STATED THAT SEVERAL STOCKPONDS WERE EROSION CONTROL STRUCTURES ONLY. THESE STOCKPONDS WERE RE-INVESTIGATED AND DELETED FROM THIS W.F.R.
CDMMENTS WERE RECEIVED FROM THE LAND OWNER WHICH STATED THAT SEVERAL FILINGS SHOULD BE ADDED AND PROVIDED THE NAMES OF SEVERAL STOCKPONDS. ALL FILINGS HAVE BEEN ADDED AND MATCHED TO THE APPROPRIATE POTENTIAL WATER RIGHTS (P.W.R.'S).
A CDMMENT WAS RECEIVED FROM THE LESSEE WHICH STATED THAT AMENDMENTS WOULD BE SUBMITTED LATER FOR SP5 AND SP10.

ATTACHMENT B

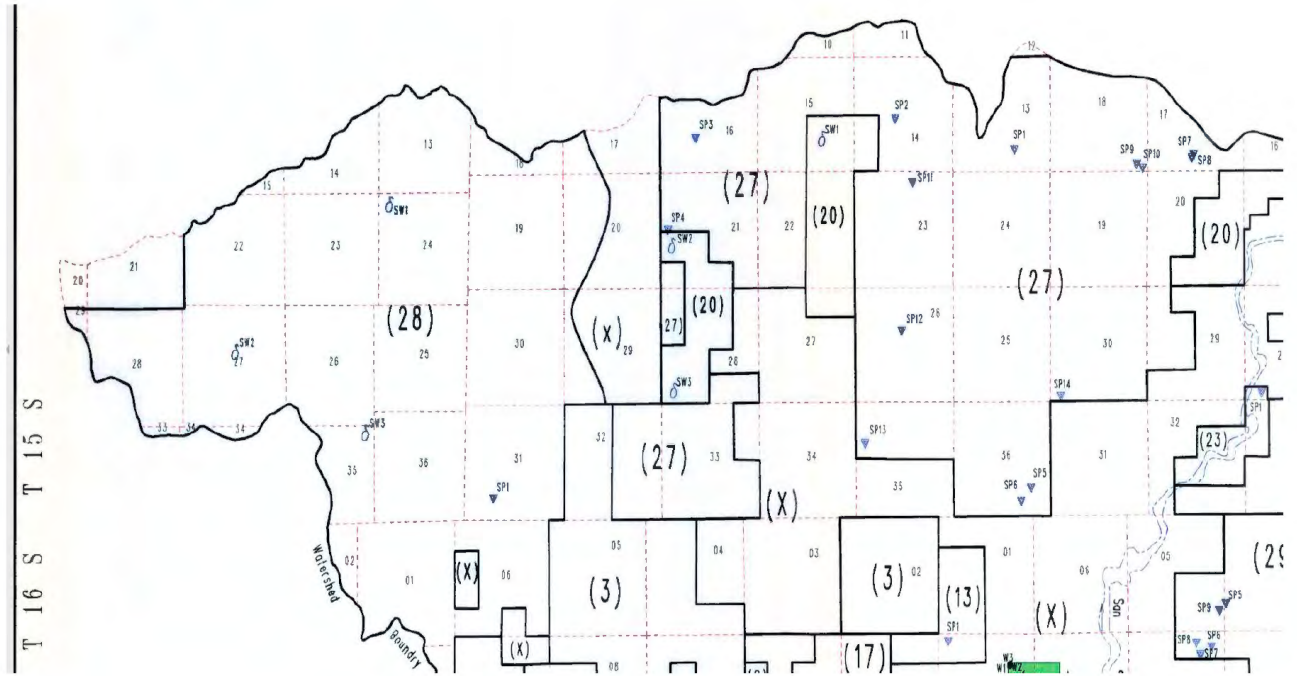

ATTACHMENT C

Attribute	Proposed Abstract of Water Right	ADWR Comments
1. Proposed Water Right No.:	112-14-027-SP001	
2. Owner of Water Right:		
3. Landowner:	State of Arizona – Arizona State Land Department	
4. Statement of Claimant No.(s):	39-2814 39-7471	
5. Statement of Claimant Name(s):	White House Ranch Arizona State Land Department	
6. Lessee:	David C. Kennedy	
7. Basis of Right:	38-13537 38-88683	
8. Beneficial Use:	Stock and wildlife watering from a stock pond	
9. Priority Date:	December 31, 1950	
10. Quantity:	Not to exceed (\leq) 4-acre feet annually with continuous refill	
11. Place of Use:	NESESE Sec. 13 T15S R19E of the Gila and Salt River Base and Meridian, Cochise County, Arizona. (see attached map)	
12. Point of Diversion:	NESESE Sec. 13 T15S R19E of the Gila and Salt River Base and Meridian, Cochise County, Arizona. (see attached map)	
13. Source of Water:	San Pedro River	
14. Facility:	Lower 13 Tank	

Attribute	Proposed Abstract of Water Right	ADWR Comments
1. Proposed Water Right No.:	112-14-027-SP002	
2. Owner of Water Right:		
3. Landowner:	State of Arizona – Arizona State Land Department	
4. Statement of Claimant No.(s):	39-2830 39-7472	
5. Statement of Claimant Name(s):	White House Ranch Arizona State Land Department	
6. Lessee:	David C. Kennedy	
7. Basis of Right:	38-15356 38-88682	
8. Beneficial Use:	Stock and wildlife watering from a stock pond	
9. Priority Date:	December 31, 1950	
10. Quantity:	Not to exceed (\leq) 4-acre feet annually with continuous refill	
11. Place of Use:	SESENW Sec. 14 T15S R19E of the Gila and Salt River Base and Meridian, Cochise County, Arizona. (see attached map)	
12. Point of Diversion:	SESENW Sec. 14 T15S R19E of the Gila and Salt River Base and Meridian, Cochise County, Arizona. (see attached map)	
13. Source of Water:	San Pedro River	
14. Facility:	Homestead Tank	

Attribute	Proposed Abstract of Water Right	ADWR Comments
1. Proposed Water Right No.:	112-14-027-SP003	
2. Owner of Water Right:		
3. Landowner:	State of Arizona – Arizona State Land Department	
4. Statement of Claimant No.(s):	39-2813 39-13388	
5. Statement of Claimant Name(s):	White House Ranch Arizona State Land Department	
6. Lessee:	David C. Kennedy	
7. Basis of Right:	38-88814	
8. Beneficial Use:	Stock and wildlife watering from a stock pond	
9. Priority Date:	December 31, 1977	
10. Quantity:	Not to exceed (\leq) 4-acre feet annually with continuous refill	
11. Place of Use:	NWNESW Sec. 16 T15S R19E of the Gila and Salt River Base and Meridian, Cochise County, Arizona. (see attached map)	
12. Point of Diversion:	NWNESW Sec. 16 T15S R19E of the Gila and Salt River Base and Meridian, Cochise County, Arizona. (see attached map)	
13. Source of Water:	San Pedro River	
14. Facility:	Section 16 Tank	

Attribute	Proposed Abstract of Water Right	ADWR Comments
1. Proposed Water Right No.:	112-14-027-SP004	
2. Owner of Water Right:		
3. Landowner:	State of Arizona – Arizona State Land Department	
4. Statement of Claimant No.(s):	39-2828 39-7473	
5. Statement of Claimant Name(s):	White House Ranch Arizona State Land Department	
6. Lessee:	David C. Kennedy	
7. Basis of Right:	3R-1576 33-78266 38-88713	
8. Beneficial Use:	Stock and wildlife watering from a stock pond	
9. Priority Date:	December 31, 1957	
10. Quantity:	Not to exceed (\leq) 4-acre feet annually with continuous refill	
11. Place of Use:	SWSWNW Sec. 21 T15S R19E of the Gila and Salt River Base and Meridian, Cochise County, Arizona. (see attached map)	
12. Point of Diversion:	SWSWNW Sec. 21 T15S R19E of the Gila and Salt River Base and Meridian, Cochise County, Arizona. (see attached map)	
13. Source of Water:	San Pedro River	
14. Facility:	Canoa Spring Tank	

Attribute	Proposed Abstract of Water Right	ADWR Comments
1. Proposed Water Right No.:	112-14-027-SP006	
2. Owner of Water Right:		
3. Landowner:	State of Arizona – Arizona State Land Department	
4. Statement of Claimant No.(s):	39-2816 39-7474	
5. Statement of Claimant Name(s):	White House Ranch Arizona State Land Department	
6. Lessee:	David C Kennedy	
7. Basis of Right:	3R-1578 38-15363 38-88627	
8. Beneficial Use:	Stock and wildlife watering from a stock pond	
9. Priority Date:	December 31, 1950	
10. Quantity:	Not to exceed (\leq) 4-acre feet annually with continuous refill	
11. Place of Use:	NESWSE Sec. 36 T15S R19E of the Gila and Salt River Base and Meridian, Cochise County, Arizona. (see attached map)	
12. Point of Diversion:	NESWSE Sec. 36 T15S R19E of the Gila and Salt River Base and Meridian, Cochise County, Arizona. (see attached map)	
13. Source of Water:	San Pedro River	
14. Facility:	Number 3 Tank	

Attribute	Proposed Abstract of Water Right	ADWR Comments
1. Proposed Water Right No.:	112-14-027-SP007	
2. Owner of Water Right:		
3. Landowner:	State of Arizona – Arizona State Land Department	
4. Statement of Claimant No.(s):	39-2819 39-7477	
5. Statement of Claimant Name(s):	White House Ranch Arizona State Land Department	
6. Lessee:	David C. Kennedy	
7. Basis of Right:	38-15365 38-88650	
8. Beneficial Use:	Stock and wildlife watering from a stock pond	
9. Priority Date:	December 31, 1950	
10. Quantity:	Not to exceed (\leq) 4-acre feet annually with continuous refill	
11. Place of Use:	NESESW Sec. 17 T15S R20E of the Gila and Salt River Base and Meridian, Cochise County, Arizona. (see attached map)	
12. Point of Diversion:	NESESW Sec. 17 T15S R20E of the Gila and Salt River Base and Meridian, Cochise County, Arizona. (see attached map)	
13. Source of Water:	San Pedro River	
14. Facility:	North Twin Tank	

Attribute	Proposed Abstract of Water Right	ADWR Comments
1. Proposed Water Right No.:	112-14-027-SP008	
2. Owner of Water Right:		
3. Landowner:	State of Arizona – Arizona State Land Department	
4. Statement of Claimant No.(s):	39-2818 39-7478	
5. Statement of Claimant Name(s):	White House Ranch Arizona State Land Department	
6. Lessee:	David C. Kennedy	
7. Basis of Right:	3R-1579 38-15366 38-88637	
8. Beneficial Use:	Stock and wildlife watering from a stock pond	
9. Priority Date:	December 31, 1950	
10. Quantity:	Not to exceed (\leq) 4-acre feet annually with continuous refill	
11. Place of Use:	NESESW Sec. 17 T15S R20E of the Gila and Salt River Base and Meridian, Cochise County, Arizona. (see attached map)	
12. Point of Diversion:	NESESW Sec. 17 T15S R20E of the Gila and Salt River Base and Meridian, Cochise County, Arizona. (see attached map)	
13. Source of Water:	San Pedro River	
14. Facility:	South Twin Tank	

Attribute	Proposed Abstract of Water Right	ADWR Comments
1. Proposed Water Right No.:	112-14-027-SP009	
2. Owner of Water Right:		
3. Landowner:	State of Arizona – Arizona State Land Department	
4. Statement of Claimant No.(s):	39-2822 39-7479	
5. Statement of Claimant Name(s):	White House Ranch Arizona State Land Department	
6. Lessee:	David C. Kennedy	
7. Basis of Right:	38-15358 38-88750	
8. Beneficial Use:	Stock and wildlife watering from a stock pond	
9. Priority Date:	December 31, 1950	
10. Quantity:	Not to exceed (\leq) 4-acre feet annually with continuous refill	
11. Place of Use:	SESESE Sec. 18 T15S R20E of the Gila and Salt River Base and Meridian, Cochise County, Arizona. (see attached map)	
12. Point of Diversion:	SESESE Sec. 18 T15S R20E of the Gila and Salt River Base and Meridian, Cochise County, Arizona. (see attached map)	
13. Source of Water:	San Pedro River	
14. Facility:	Section 18 Tank	

Attribute	Proposed Abstract of Water Right	ADWR Comments
1. Proposed Water Right No.:	112-14-027-SP010	
2. Owner of Water Right:		
3. Landowner:	State of Arizona – Arizona State Land Department	
4. Statement of Claimant No.(s):	39-13394	
5. Statement of Claimant Name(s):	Arizona State Land Department	
6. Lessee:	David C. Kennedy	
7. Basis of Right:	38-94537	
8. Beneficial Use:	Stock and wildlife watering from a stock pond	
9. Priority Date:	December 31, 1972	
10. Quantity:	Not to exceed (\leq) 4-acre feet annually with continuous refill	
11. Place of Use:	SESESE Sec. 18 T15S R20E of the Gila and Salt River Base and Meridian, Cochise County, Arizona. (see attached map)	
12. Point of Diversion:	SESESE Sec. 18 T15S R20E of the Gila and Salt River Base and Meridian, Cochise County, Arizona. (see attached map)	
13. Source of Water:	San Pedro River	
14. Facility:	Lower Section 18 Tank	

Attribute	Proposed Abstract of Water Right	ADWR Comments
1. Proposed Water Right No.:	112-14-027-SP0011	
2. Owner of Water Right:		
3. Landowner:	State of Arizona – Arizona State Land Department	
4. Statement of Claimant No.(s):	39-2823 39-11158 39-11167	
5. Statement of Claimant Name(s):	White House Ranch Arizona State Land Department	
6. Lessee:	David C. Kennedy	
7. Basis of Right:	38-15360 38-23188	
8. Beneficial Use:	Stock and wildlife watering from a stock pond	
9. Priority Date:	December 31, 1950	
10. Quantity:	Not to exceed (\leq) 4-acre feet annually with continuous refill	
11. Place of Use:	NWNWNE Sec. 23 T15S R19E of the Gila and Salt River Base and Meridian, Cochise County, Arizona. (see attached map)	
12. Point of Diversion:	NWNWNE Sec. 23 T15S R19E of the Gila and Salt River Base and Meridian, Cochise County, Arizona. (see attached map)	
13. Source of Water:	San Pedro River	
14. Facility:	Section 23 Tank	

Attribute	Proposed Abstract of Water Right	ADWR Comments
1. Proposed Water Right No.:	112-14-027-SP012	
2. Owner of Water Right:		
3. Landowner:	State of Arizona – Arizona State Land Department	
4. Statement of Claimant No.(s):	39-2827 39-11168	
5. Statement of Claimant Name(s):	White House Ranch Arizona State Land Department	
6. Lessee:	David C. Kennedy	
7. Basis of Right:	38-15361 38-88815 38-88796	
8. Beneficial Use:	Stock and wildlife watering from a stock pond	
9. Priority Date:	December 31, 1950	
10. Quantity:	Not to exceed (\leq) 4-acre feet annually with continuous refill	
11. Place of Use:	NESENW Sec. 26 T15S R19E of the Gila and Salt River Base and Meridian, Cochise County, Arizona. (see attached map)	
12. Point of Diversion:	NESENW Sec. 26 T15S R19E of the Gila and Salt River Base and Meridian, Cochise County, Arizona. (see attached map)	
13. Source of Water:	San Pedro River	
14. Facility:	Section 26 Tank	

Attribute	Proposed Abstract of Water Right	ADWR Comments
1. Proposed Water Right No.:	112-14-027-SP013	
2. Owner of Water Right:		
3. Landowner:	State of Arizona – Arizona State Land Department	
4. Statement of Claimant No.(s):	39-2815 39-11166	
5. Statement of Claimant Name(s):	White House Ranch Arizona State Land Department	
6. Lessee:	David C. Kennedy	
7. Basis of Right:	38-15362 38-94753	
8. Beneficial Use:	Stock and wildlife watering from a stock pond	
9. Priority Date:	December 31, 1950	
10. Quantity:	Not to exceed (\leq) 4-acre feet annually with continuous refill	
11. Place of Use:	NWSWNW Sec. 35 T15S R19E of the Gila and Salt River Base and Meridian, Cochise County, Arizona. (see attached map)	
12. Point of Diversion:	NWSWNW Sec. 35 T15S R19E of the Gila and Salt River Base and Meridian, Cochise County, Arizona. (see attached map)	
13. Source of Water:	San Pedro River	
14. Facility:	Section 35 Tank	

Attribute	Proposed Abstract of Water Right	ADWR Comments
1. Proposed Water Right No.:	112-14-027-SP014	
2. Owner of Water Right:		
3. Landowner:	State of Arizona – Arizona State Land Department	
4. Statement of Claimant No.(s):	39-2817 39-7480	
5. Statement of Claimant Name(s):	White House Ranch Arizona State Land Department	
6. Lessee:	David C. Kennedy	
7. Basis of Right:	38-15364 38-88389	
8. Beneficial Use:	Stock and wildlife watering from a stock pond	
9. Priority Date:	December 31, 1950	
10. Quantity:	Not to exceed (\leq) 4-acre feet annually with continuous refill	
11. Place of Use:	SWSWSW Sec. 30 T15S R20E of the Gila and Salt River Base and Meridian, Cochise County, Arizona. (see attached map)	
12. Point of Diversion:	SWSWSW Sec. 30 T15S R20E of the Gila and Salt River Base and Meridian, Cochise County, Arizona. (see attached map)	
13. Source of Water:	San Pedro River	
14. Facility:	Road Mill Tank	

Attribute	Proposed Abstract of Water Right	ADWR Comments
1. Proposed Water Right No.:	112-14-027-SP015	
2. Owner of Water Right:		
3. Landowner:	State of Arizona – Arizona State Land Department	
4. Statement of Claimant No.(s):	39-2821 39-13389	
5. Statement of Claimant Name(s):	White House Ranch Arizona State Land Department	
6. Lessee:	David C. Kennedy	
7. Basis of Right:	38-15359 38-94633	
8. Beneficial Use:	Stock and wildlife watering from a stock pond	
9. Priority Date:	December 31, 1950	
10. Quantity:	Not to exceed (\leq) 4-acre feet annually with continuous refill	
11. Place of Use:	SESENW Sec. 21 T15S R19E of the Gila and Salt River Base and Meridian, Cochise County, Arizona. (see attached map)	
12. Point of Diversion:	SESENW Sec. 21 T15S R19E of the Gila and Salt River Base and Meridian, Cochise County, Arizona. (see attached map)	
13. Source of Water:	San Pedro River	
14. Facility:	Section 21 Tank	

Attribute	Proposed Abstract of Water Right	ADWR Comments
1. Proposed Water Right No.:	112-14-027-SW002	
2. Owner of Water Right:		
3. Landowner:	State of Arizona- State Land Department	
4. Statement of Claimant No.(s):	39-7471	
5. Statement of Claimant Name(s):	Arizona State Land Department	
6. Lessee:	David C. Kennedy	
7. Basis of Right:	36-5275	
8. Beneficial Use:	Stock and wildlife watering	
9. Priority Date:	December 31, 1884	
10. Quantity:	Reasonable use	
11. Place of Use:	NENESW Sec. 13 T15S R19E of the Gila and Salt River Base and Meridian, Cochise County, Arizona. (see attached map)	
12. Point of Diversion:	NENESW Sec. 13 T15S R19E of the Gila and Salt River Base and Meridian, Cochise County, Arizona. (see attached map)	
13. Source of Water:	Lower Wash	

Attribute	Proposed Abstract of Water Right	ADWR Comments
1. Proposed Water Right No.:	112-14-027-SW003	
2. Owner of Water Right:		
3. Landowner:	State of Arizona- State Land Department	
4. Statement of Claimant No.(s):	39-7472	
5. Statement of Claimant Name(s):	Arizona State Land Department	
6. Lessee:	David C. Kennedy	
7. Basis of Right:	36-5276	
8. Beneficial Use:	Stock and wildlife watering	
9. Priority Date:	December 31, 1884	
10. Quantity:	Reasonable use	
11. Place of Use:	SESESW Sec. 11 T15S R19E of the Gila and Salt River Base and Meridian, Cochise County, Arizona. (see attached map)	
12. Point of Diversion:	SESESW Sec. 11 T15S R19E of the Gila and Salt River Base and Meridian, Cochise County, Arizona. (see attached map)	
13. Source of Water:	Homestead Wash	

Attribute	Proposed Abstract of Water Right	ADWR Comments
1. Proposed Water Right No.:	112-14-027-SW004	
2. Owner of Water Right:		
3. Landowner:	State of Arizona- State Land Department	
4. Statement of Claimant No.(s):	39-13388	
5. Statement of Claimant Name(s):	Arizona State Land Department	
6. Lessee:	David C. Kennedy	
7. Basis of Right:	36-5613	
8. Beneficial Use:	Stock and wildlife watering	
9. Priority Date:	December 31, 1884	
10. Quantity:	Reasonable use	
11. Place of Use:	SWSWNW Sec.16 T15S R19E of the Gila and Salt River Base and Meridian, Cochise County, Arizona. (see attached map)	
12. Point of Diversion:	SWSWNW Sec.16 T15S R19E of the Gila and Salt River Base and Meridian, Cochise County, Arizona. (see attached map)	
13. Source of Water:	Trail Wash I	

Attribute	Proposed Abstract of Water Right	ADWR Comments
1. Proposed Water Right No.:	112-14-027-SW005	
2. Owner of Water Right:		
3. Landowner:	State of Arizona- State Land Department	
4. Statement of Claimant No.(s):	39-7473	
5. Statement of Claimant Name(s):	Arizona State Land Department	
6. Lessee:	David C. Kennedy	
7. Basis of Right:	36-5277	
8. Beneficial Use:	Stock and wildlife watering	
9. Priority Date:	December 31, 1884	
10. Quantity:	Reasonable use	
11. Place of Use:	NESWSE Sec. 17 T15S R19E of the Gila and Salt River Base and Meridian, Cochise County, Arizona. (see attached map)	
12. Point of Diversion:	NESWSE Sec. 17 T15S R19E of the Gila and Salt River Base and Meridian, Cochise County, Arizona. (see attached map)	
13. Source of Water:	Canoa Wash	

Attribute	Proposed Abstract of Water Right	ADWR Comments
1. Proposed Water Right No.:	112-14-027-SW006	
2. Owner of Water Right:		
3. Landowner:	State of Arizona- State Land Department	
4. Statement of Claimant No.(s):	39-7474	
5. Statement of Claimant Name(s):	Arizona State Land Department	
6. Lessee:	David C. Kennedy	
7. Basis of Right:	36-5278	
8. Beneficial Use:	Stock and wildlife watering	
9. Priority Date:	December 31, 1884	
10. Quantity:	Reasonable use	
11. Place of Use:	NWNWSE Sec. 36 T15S R19E of the Gila and Salt River Base and Meridian, Cochise County, Arizona. (see attached map)	
12. Point of Diversion:	NWNWSE Sec. 36 T15S R19E of the Gila and Salt River Base and Meridian, Cochise County, Arizona. (see attached map)	
13. Source of Water:	Willow Wash	

Attribute	Proposed Abstract of Water Right	ADWR Comments
1. Proposed Water Right No.:	112-14-027-SW007	
2. Owner of Water Right:		
3. Landowner:	State of Arizona- State Land Department	
4. Statement of Claimant No.(s):	39-7477 39-7478	
5. Statement of Claimant Name(s):	Arizona State Land Department	
6. Lessee:	David C. Kennedy	
7. Basis of Right:	36-5280 36-5281	
8. Beneficial Use:	Stock and wildlife watering	
9. Priority Date:	December 31, 1884	
10. Quantity:	Reasonable use	
11. Place of Use:	SESESW Sec. 17 T15S R20E of the Gila and Salt River Base and Meridian, Cochise County, Arizona. (see attached map)	
12. Point of Diversion:	SESESW Sec. 17 T15S R20E of the Gila and Salt River Base and Meridian, Cochise County, Arizona. (see attached map)	
13. Source of Water:	Upper Wash	

Attribute	Proposed Abstract of Water Right	ADWR Comments
1. Proposed Water Right No.:	112-14-027-SW008	
2. Owner of Water Right:		
3. Landowner:	State of Arizona- State Land Department	
4. Statement of Claimant No.(s):	39-7479	
5. Statement of Claimant Name(s):	Arizona State Land Department	
6. Lessee:	David C. Kennedy	
7. Basis of Right:	36-5282	
8. Beneficial Use:	Stock and wildlife watering	
9. Priority Date:	December 31, 1884	
10. Quantity:	Reasonable use	
11. Place of Use:	NESWSE Sec. 18 T15S R20E of the Gila and Salt River Base and Meridian, Cochise County, Arizona. (see attached map)	
12. Point of Diversion:	NESWSE Sec. 18 T15S R20E of the Gila and Salt River Base and Meridian, Cochise County, Arizona. (see attached map)	
13. Source of Water:	Small Wash	

Attribute	Proposed Abstract of Water Right	ADWR Comments
1. Proposed Water Right No.:	112-14-027-SW009	
2. Owner of Water Right:		
3. Landowner:	State of Arizona- State Land Department	
4. Statement of Claimant No.(s):	39-11167	
5. Statement of Claimant Name(s):	Arizona State Land Department	
6. Lessee:	David C. Kennedy	
7. Basis of Right:	36-100074	
8. Beneficial Use:	Stock and wildlife watering	
9. Priority Date:	December 31, 1884	
10. Quantity:	Reasonable use	
11. Place of Use:	NWSWSE Sec. 14 T15S R19E of the Gila and Salt River Base and Meridian, Cochise County, Arizona. (see attached map)	
12. Point of Diversion:	NWSWSE Sec. 14 T15S R19E of the Gila and Salt River Base and Meridian, Cochise County, Arizona. (see attached map)	
13. Source of Water:	Tank Draw	

Attribute	Proposed Abstract of Water Right	ADWR Comments
1. Proposed Water Right No.:	112-14-027-SW010	
2. Owner of Water Right:		
3. Landowner:	State of Arizona- State Land Department	
4. Statement of Claimant No.(s):	39-11168	
5. Statement of Claimant Name(s):	Arizona State Land Department	
6. Lessee:	David C. Kennedy	
7. Basis of Right:	36-100076	
8. Beneficial Use:	Stock and wildlife watering	
9. Priority Date:	December 31, 1884	
10. Quantity:	Reasonable use	
11. Place of Use:	NWNESW Sec. 23 T15S R19E of the Gila and Salt River Base and Meridian, Cochise County, Arizona. (see attached map)	
12. Point of Diversion:	NWNESW Sec. 23 T15S R19E of the Gila and Salt River Base and Meridian, Cochise County, Arizona. (see attached map)	
13. Source of Water:	Road Wash	

Attribute	Proposed Abstract of Water Right	ADWR Comments
1. Proposed Water Right No.:	112-14-027-SW011	
2. Owner of Water Right:		
3. Landowner:	State of Arizona- State Land Department	
4. Statement of Claimant No.(s):	39-11166	
5. Statement of Claimant Name(s):	Arizona State Land Department	
6. Lessee:	David C. Kennedy	
7. Basis of Right:	36-100077	
8. Beneficial Use:	Stock and wildlife watering	
9. Priority Date:	December 31, 1884	
10. Quantity:	Reasonable use	
11. Place of Use:	NWNWNW Sec. 35 T15S 19E of the Gila and Salt River Base and Meridian, Cochise County, Arizona. (see attached map)	
12. Point of Diversion:	NWNWNW Sec. 35 T15S 19E of the Gila and Salt River Base and Meridian, Cochise County, Arizona. (see attached map)	
13. Source of Water:	3S Draw	

Attribute	Proposed Abstract of Water Right	ADWR Comments
1. Proposed Water Right No.:	112-14-027-SW012	
2. Owner of Water Right:		
3. Landowner:	State of Arizona- State Land Department	
4. Statement of Claimant No.(s):	39-7480	
5. Statement of Claimant Name(s):	Arizona State Land Department	
6. Lessee:	David C. Kennedy	
7. Basis of Right:	36-5283	
8. Beneficial Use:	Stock and wildlife watering	
9. Priority Date:	December 31, 1884	
10. Quantity:	Reasonable use	
11. Place of Use:	NESWNE Sec. 25 T15S 19E of the Gila and Salt River Base and Meridian, Cochise County, Arizona. (see attached map)	
12. Point of Diversion:	NESWNE Sec. 25 T15S 19E of the Gila and Salt River Base and Meridian, Cochise County, Arizona. (see attached map)	
13. Source of Water:	Mill Wash	

Attribute	Proposed Abstract of Water Right	ADWR Comments
1. Proposed Water Right No.:	112-14-027-SW013	
2. Owner of Water Right:		
3. Landowner:	State of Arizona- State Land Department	
4. Statement of Claimant No.(s):	39-13389	
5. Statement of Claimant Name(s):	Arizona State Land Department	
6. Lessee:	David C. Kennedy	
7. Basis of Right:	36-5614	
8. Beneficial Use:	Stock and wildlife watering	
9. Priority Date:	December 31, 1884	
10. Quantity:	Reasonable use	
11. Place of Use:	SESENW Sec. 21 T15S 19E of the Gila and Salt River Base and Meridian, Cochise County, Arizona. (see attached map)	
12. Point of Diversion:	SESENW Sec. 21 T15S 19E of the Gila and Salt River Base and Meridian, Cochise County, Arizona. (see attached map)	
13. Source of Water:	Trail Wash II	

Attribute	Proposed Abstract of Water Right	ADWR Comments
1. Proposed Water Right No.:	112-14-027-SW014	
2. Owner of Water Right:		
3. Landowner:	State of Arizona- State Land Department	
4. Statement of Claimant No.(s):	39-13394	
5. Statement of Claimant Name(s):	Arizona State Land Department	
6. Lessee:	David. C. Kennedy	
7. Basis of Right:	36-5618	
8. Beneficial Use:	Stock and wildlife watering	
9. Priority Date:	December 31, 1884	
10. Quantity:	Reasonable use	
11. Place of Use:	SWSESE Sec. 18 T15S 20E of the Gila and Salt River Base and Meridian, Cochise County, Arizona. (see attached map)	
12. Point of Diversion:	SWSESE Sec. 18 T15S 20E of the Gila and Salt River Base and Meridian, Cochise County, Arizona. (see attached map)	
13. Source of Water:	Number 18 Draw	

ATTACHMENT D

Arizona Department of Water Resources
Kimberly Parks
P. O. Box 36020
Phoenix, AZ 85067

Carrie Brennan and Kevin Crestin
Arizona Attorney General
Natural Resources Department
2005 N. Central
Phoenix, Az 85004

Joe P. Sparks and Laurel A. Herrmann
The Sparks Law Firm, P.C.
7503 First Street
Scottsdale, Az 85251-4573

Richard Palmer, Jr., Jeremiah Weiner
and Lauren Mulhern
Rosette, LLP
565 W. Chandler Blvd. Suite 212
Chandler, AZ 85225

S. Montgomery, R. Interpreter, J. Tomkus
Montgomery & Interpreter, Plc
3301 E. Thunderbird Road
Phoenix, AZ 85032

Salt River Project
John B. Weldon, Jr. and Mark A. McGinnis
Salmon, Lewis & Weldon PLC
2850 E Camelback Rd, Ste. 200
Phoenix, AZ 85016

Linus Everling, Thomas Murphy
Gila River Indian Community
Office of the General Counsel
P O. Box 97
Sacaton, AZ 85147

Carla Consoli
Lewis, Roca, Rothgerber & Christie, LLP
The Nature Conservancy
201 E Washington Street
Ste. 1200
Phoenix, AZ 85004

David and Susan Kennedy
P.O. Box 2378
Benson, AZ 85602

H. Clifford Dobson Jr.
Carolyn Dobson
Rural Route 1, Box 1546
Willcox, AZ 85643

White House Ranch
2621 E. Camelback Road
Suite 190
Phoenix, AZ 85016

White House Ranch, LLC
16651 S. Lone Heart Rd.
P.O. Box 1641
Sahuarita, AZ 85629

Charles L Cahoy
Assistant City Attorney
City of Phoenix
P. O. Box 27210
Phoenix, AZ 85003

Patrick Barry
U. S. Department of Justice
Environmental and Natural Resources
P. O. Box 7611
Washington, D.C. 20044-7611

Clerk of the Superior Court Maricopa
County
Attn: Water Case
601 West Jackson Street
Phoenix, AZ 85003

Special Master Susan Ward Harris
Superior Court of Arizona
201 W. Jefferson Street
Courtroom 301
Phoenix, AZ 85003